



OUTSTANDING FEATURES

TOUCH II microprocessor: easy to use and fully programmable with 4.3" touch screen.
Frequency control standard.
Reverse drum action standard.
USB port.
Remote connection.



VERSATILITY

OPL<>COIN
The same model can be easily transformed.
Ideal for many sectors: hotels, camp sites, self-service laundries, gyms, etc.



EFFICIENCY

EFFICIENT DRY: humidity sensor.
Improved air flow system.
Big fluff filter as a drawer.
Efficient design.



CONNECTIVITY

Standard IoT **DOMUSCONNECT**
Management for laundries: OPL and self-service.



ROBUSTNESS

Outer casing in grey skinplate.
Robust aluminium door.
Drawer as a fluff filter (not in the door but in a dedicated drawer).
Industrial fan and powerful airflow.
More robust construction of structure and panels.



OTHERS

FULL SCREEN FILTER: Fluff filter as drawer, not in the door.
CE-certified



OPTIONS

- 400V-480V III 50/60 no N (CHECK PRICE)
- DOMUS LAUNDRY App - Self service
- License IoT - DOMUSCONNECT
- Drum stainless steel AISI 304
- Reverse door opening
- Outer casing stainless steel for HPi AISI 430
- Tropicalized model (TOUCH II)
- Several payment systems for self-service

CAPACITY & DRUM		UNIT.	HPD-8 TOUCH II HPI
Capacity 1/18		Kg	8,9
		lb	19,6
Capacity 1/20		Kg	8
		lb	17,6
Ø Drum		mm	590
		inch	23,2
Drum length		mm	585
		inch	23
Drum volume		l	160
		cu ft	5,65
Ø Door hole		mm	480
		inch	18,9
Door center height		mm	918
		inch	36,1
Height from floor to bottom of door		mm	614
		inch	24,17
ELECTRIC HEATING			
Evaporation capacity		L/h	4,2
		US gallon/h	1,11
Hourly output		Kg/h	8,4
		lb/h	18,52
Installed heating power		kW	2
Installed electrical power		kW	2,74
Drum motor power		kW	0,37
GAS HEATING			
VENTILATION			
Fan motor power		kW	0,17
Nominal air flow rate		m³/h	Variable
		cfm	Variable
Ø Fume exhaust		mm	-
		inch	-
HEAT EMISSION			
Maximum total heat emission		kW	0,3
		Btu/h	1075
Max. front heat emission		kW	0,2
		Btu/h	753
CONNECTIONS			
NET DIMENSIONS / D. WITH PACKING			
Net / gross width		mm	680 / 710
		inch	26,8 / 28
Net / gross depth		mm	750 / 832
		inch	29,5 / 32,8
Net / gross height		mm	1.400 / 1.520
		inch	55,1 / 59,8
Net / gross weight		Kg	165 / 174
		lb	364 / 384
OTHERS			
Sound level		dB	61

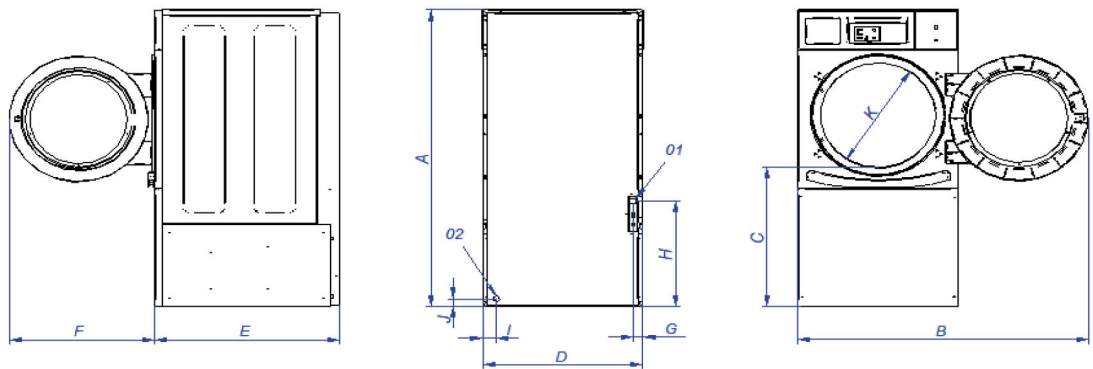

01. Electrical connection
 02. Condensed water evacuation
 3000mm hose (1) and 12mm inner diameter
 (1) For greater distances, consult the installation manual.

		A	B	C	D	E	F	G	H	I	J	K
HPD-8 TOUCH II HPI	mm	1.400	1.227	665	680	784	615	42	505	60	50	480
HPD-10 TOUCH II HPI	mm	1.400	1.227	665	680	784	615	42	505	60	50	480