

ELECTRONIC PROGRAMMER

M programmer: push buttons to control temperature and time.

OUTSTANDING FEATURES

Reversing drum action as standard.
Stainless steel drum as standard.
Frequency inverter as standard.

EFFICIENCY

DOUBLE FLOW - mixed axial-radial airflow.
Big fluff filter.

VERSATILITY

Make to order - Customisation
OPL > Self-service - Standard OPL model easily trasformable to coin laundry uses.

ERGONOMICS

Drawer as fluff filter, stainless steel mesh.
Biggest door diameters.

MAINTENANCE

Hinged control panel: easy and ergonomic access.
Technical menu: statistics for technicians and maintenance with external console (with console option).

OTHERS

Grey skinplate outer casing, stainless steel look.
SOFT DRY - new drum with stamped holes.
COOL DOWN - anti-wrinkle at the end of the cycle.
Heating options: electric or gas, except DTM2-22 only gas.
CE approved



OPTIONS

- Natural gas heated tumble dryer
- Double doorglass (order 1 unit per column)
- Screen in M programmer (2 units)
- Fluff filter with grid 0,3 mm (standard in STACK is 0,6 mm)
- Stainless steel front and side panels DTM2-18
- Front panel in stainless steel DTM2-11/14/18
- Maritime wooden packing DTM2-18
- 400V III 50Hz 11/14/18kg
- 400V III 60Hz 11/14/18/22kg
- 230V III 60Hz 11/14/18kg G
- 230V III 60Hz 11/14/18kg E
- 440V/480V III 60Hz 11/14/18/22kg (maritime)
- Several payment systems for self-service

CAPACITY & DRUM	UNIT.	DTM2-18 TURBO	
Capacity 1/18	Kg	18,3 x2	
	lb	40,4 x2	
Capacity 1/20	Kg	16,5 x2	
	lb	36,3 x2	
Ø Drum	mm	750	
	inch	29,53	
Drum length	mm	746	
	inch	29,37	
Drum volume	l	330	
	cu ft	11,64	
Ø Door hole	mm	574	
	inch	22,60	
Door center height	mm	547 / 1522	
	inch	21,54 / 59,92	
Height from floor to bottom of door	mm	260 / 1.235	
	inch	10,24 / 48,62	
ELECTRIC HEATING			
Evaporation capacity	L/h	-	
	US gallon/h	-	
Hourly output	Kg/h	-	
	lb/h	-	
Installed heating power	kW	-	
Installed electrical power	kW	-	
Drum motor power	kW	0,37 x2	
GAS HEATING			
Evaporation capacity (gas model)	L/h	35,3 x2	
	US gallon/h	9,325 x2	
Hourly output (gas model)	Kg/h	70,7 x2	
	lb/h	155,9 x2	
Installed gas heating power	kcal/h	20650 x2	
	Btu/h	81891,4 x2	
Installed gas heating power	kW	24 x2	
Installed electrical power	kW	1,94	
Instant propane gas consumption (G31)	Kg/h	2,06 x2	
	lb/h	4,54 x2	
Instant natural gas consumption (G20)	m ³ /h	2,54 x2	
	cfm	1,49 x2	
Ø Gas inlet	BSPP ISO 228-1	1/2"	
VENTILATION			
Fan motor power	kW	0,55 x2	
Nominal air flow rate	m ³ /h	750 x2	
	cfm	441,43 x2	
Ø Fume exhaust	mm	200 x2	
	inch	7,78 x2	
HEAT EMISSION			
Maximum total heat emission	kW	2,5	
	Btu/h	8353,4	
Max. front heat emission	kW	1,8	
	Btu/h	6145,5	
CONNECTIONS		E	G / S
Tension 230V - I + N + T	Nº x mm ² / A	-	3 x 2,5 / 20A
Tension 230V - III + T	Nº x mm ² / A	-	3 x 2,5 / 20A (1*)
Tension 400V - III + N + T	Nº x mm ² / A	-	3 x 2,5 / 20A (2*)
NET DIMENSIONS / D. WITH PACKING			
Net / gross width	mm	785 / 865	
	inch	30,91 / 34,06	

Net / gross depth	mm	1.443 / 1.457
	inch	53,81 / 57,36
Net / gross height	mm	1.980 / 2.126
	inch	77,95 / 83,70
Net / gross weight	Kg	320 / 349
	lb	705,48 / 769,41
OTHERS		
Sound level	dB	64

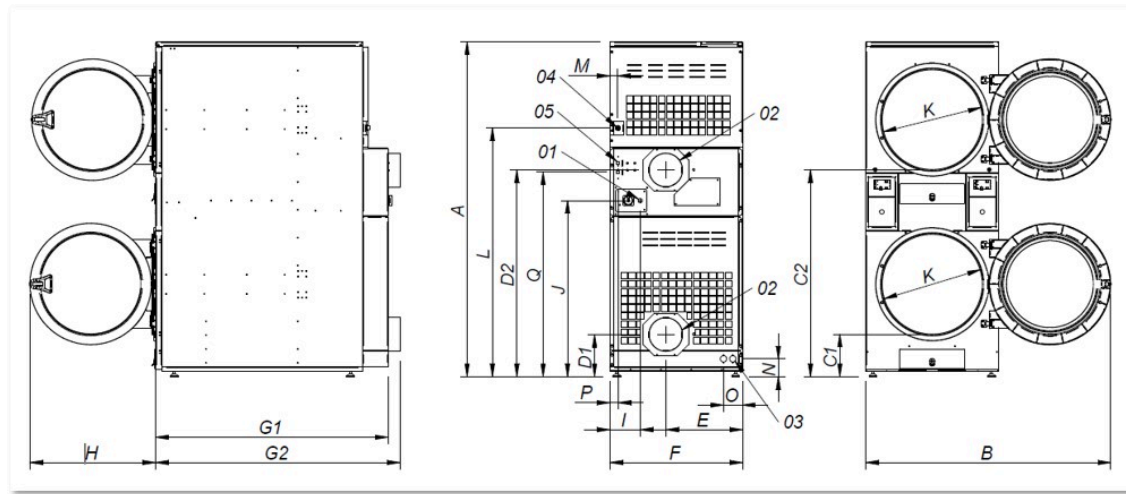

	A	B	C1	C2	D1	D2	E	F	G1	G2	H	I	J	K	L	M	N	O	P	Q
DTM2-18 TURBO	1.980	1.447	259	1.234	250	1.223	454	785	1.374	1.443	735	180	1.040	575	1.472	45	103	100	49	1.210