

TOUCH II

User friendly and totally programmable microprocessor with 7" touch screen.
 USB Connection.
 Online platform free of charge for programming, telemetry, data analysis...thanks to the IoT.
 Videos shown on display: ads, instructions (useful for coin laundry).
 37 languages.

OUTSTANDING FEATURES

Reversing drum action as standard.
 Stainless steel drum as standard.
 Frequency inverter as standard.

EFFICIENCY

EFFICIENT DRY - Intelligent humidity control, with new drum inlet temperature control.
 AIR RE-CYCLE - Efficient air recirculation system.
 THERMAL INSULATION - Complete air-flow circuit and double door glass.
 FULL FLOW - Optimized system with mixed airflow.
 Big fluff filter.

VERSATILITY

Make to order - customisation.
 Wet Cleaning.

CONNECTIVITY

Standard IoT **DOMUSCONNECT**.
 Management for laundries: OPL and self-service.

ERGONOMICS

Drawer as fluff filter, stainless steel mesh.
 Biggest door diameters.
 Opening sense of door adjustable on site.

MAINTENANCE

Hinged control panel: easy and ergonomic access.
 Technical menu: statistics for technicians.

OTHERS

Grey skinplate outer casing, stainless steel look.
NEW: Geared motor drive on models DTT-45 to DTT-80
 SFEX - Integrated Fire Extinguishing System.
 SOFT DRY - new drum with stamped holes.
 COOL DOWN - anti-wrinkle at the end of the cycle.
 Heating options: electric, gas and steam.
 CE approved



OPTIONS

- License IoT - DOMUSCONNECT
- Back panel with air filter DTT-11 to DTT-35
- Natural gas heated tumble dryer
- Opposite door opening DTT-11 to DTT-35
- Tropicalized model
- Dosing spraying of perfume
- Fluff filter with grid 0,6mm (standard is 0,3mm)
- Fluff filter with grid 1,2mm (standard is 0,3mm)
- Stainless steel front and side panels DTT-28
- Front panel in stainless steel DTT-28/35
- Steam battery in stainless steel DTT-28/35
- Low pressure steam battery DTT-28/35
- Maritime wooden packing DTT-28
- 400V III 60Hz DTT-11 to DTT-35
- 230V III 50Hz DTT-22/28/35 E
- 230V III 60Hz DTT-22/28/35 E
- 230V III 60Hz DTT-11 to DTT-35 G/S
- 440/480V III 60Hz DTT-22/28/35 (maritime)

| CAPACITY & DRUM | UNIT. | DTT-28 ECO-ENERGY |
|--|--------------------------|-------------------|
| Capacity 1/18 | Kg | 30,6 |
| | lb | 67,3 |
| Capacity 1/20 | Kg | 27,5 |
| | lb | 60,6 |
| Ø Drum | mm | 947 |
| | inch | 37,28 |
| Drum length | mm | 780 |
| | inch | 30,71 |
| Drum volume | l | 550 |
| | cu ft | 19,42 |
| Ø Door hole | mm | 802 |
| | inch | 31,57 |
| Door center height | mm | 1.040 |
| | inch | 40,94 |
| Height from floor to bottom of door | mm | 578 |
| | inch | 22,74 |
| ELECTRIC HEATING | | |
| Evaporation capacity | L/h | 26,80 |
| | US gallon/h | 7,1 |
| Hourly output | Kg/h | 51,60 |
| | lb/h | 113,8 |
| Installed heating power | kW | 30 |
| Installed electrical power | kW | 31,35 |
| Drum motor power | kW | 0,55 |
| GAS HEATING | | |
| Evaporation capacity (gas model) | L/h | 31,80 |
| | US gallon/h | 8,401 |
| Hourly output (gas model) | Kg/h | 61,10 |
| | lb/h | 134,7 |
| Installed gas heating power | kcal/h | 35276 |
| | Btu/h | 139986,5 |
| Installed gas heating power | kW | 41 |
| Installed electrical power | kW | 1,35 |
| Instant propane gas consumption (G31) | Kg/h | 3,51 |
| | lb/h | 7,74 |
| Instant natural gas consumption (G20) | m ³ /h | 4,34 |
| | cfm | 2,55 |
| Ø Gas inlet | BSPP ISO 228-1 | 1/2" |
| STEAM HEATING | | |
| Installed steam heating power | kW | 50,10 |
| | Btu/h | 170948 |
| Installed electrical power | kW | 1,35 |
| Steam consumption (8 barG) - Standard | kg/h | 89 |
| Steam consumption (116 psiG) | lb/h | 107,2 |
| Steam pressure | barG | 6 - 9 |
| | psiG | 87 - 130,5 |
| Standard steam inlet - outlet | BSPT- ISO7.1 | 1" |
| Standard steam inlet - outlet | NPT ANSI B1.20.1 Tapered | 1" |
| Steam consumption (5 barG) - Low Pressure | kg/h | 93 |
| Steam consumption (72,5 psiG) - Low Pressure | lb/h | 112 |
| Steam pressure (low pressure) | barG | 3 - 6 |
| | psiG | 43,5 - 96 |
| Low pressure steam inlet - outlet | BSPT- ISO7.1 | 1" 1/2 |
| THERMAL OIL HEATING | | |
| Installed heating power | kW | - |
| Installed electrical power | kW | - |
| Fluid consumption (T max 175°C) | m ³ /h | - |

| | | | |
|---|--------------------------|-----------------|---------------|
| Thermal oil connection | BSP | - | |
| VENTILATION | | | |
| Fan motor power | kW | 0,75 | |
| Nominal air flow rate | m ³ /h | 1.500 | |
| | cfm | 882,87 | |
| Ø Fume exhaust | mm | 200 | |
| | inch | 7,87 | |
| HEAT EMISSION | | | |
| Maximum total heat emission | kW | 2,4 | |
| | Btu/h | 8193,9 | |
| Max. front heat emission | kW | 1,5 | |
| | Btu/h | 5121,2 | |
| CONNECTIONS | | | |
| Tension 230V - I + N + T | Nº x mm ² / A | E | G / S |
| Tension 230V - III + T | Nº x mm ² / A | 4 x 35 / 100A | 3 x 1,5 / 16A |
| Tension 400V - III + N + T | Nº x mm ² / A | 5 x 16 / 63A | 3 x 1,5 / 16A |
| NET DIMENSIONS / D. WITH PACKING | | | |
| Net / gross width | mm | 985 / 1.065 | |
| | inch | 38,78 / 41,93 | |
| Net / gross depth | mm | 1.054 / 1.154 | |
| | inch | 41,50 / 45,43 | |
| Net height / gross height | mm | 1.975 / 2.080 | |
| | inch | 77,76 / 81,89 | |
| Net / gross weight | Kg | 230 / 260 | |
| | lb | 507,06 / 573,20 | |
| OTHERS | | | |
| Sound level | dB | 65 | |

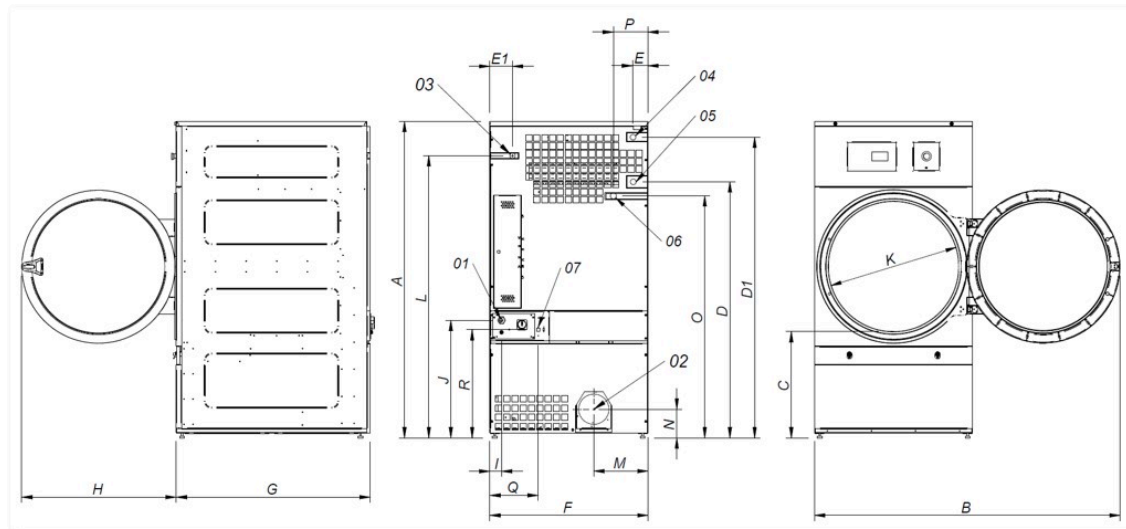

- 01 Power supply
- 02 Fumes output Ø 200
- 03 Gas inlet 1/2"
- 04 Steam inlet 1"
- 05 Condensate 1"
- 06 Sprinkler valve 3/4"
- 07 Ethernet connection (only TOUCH Control)

| | A | B | C | D | D1 | E | E1 | F | G | H | I | J | K | L | M | N | O | P | Q | R |
|-------------------|-------|-------|-----|-------|-------|-----|-----|-----|-------|-----|----|-----|-----|-------|-----|-----|-------|-----|-----|-----|
| DTT-28 ECO-ENERGY | 1.975 | 1.910 | 660 | 1.590 | 1.875 | 102 | 130 | 985 | 1.054 | 970 | 70 | 730 | 802 | 1.760 | 337 | 178 | 1.510 | 215 | 301 | 676 |
| DTT-35 ECO-ENERGY | 1.975 | 1.910 | 660 | 1.590 | 1.875 | 102 | 130 | 985 | 1.210 | 970 | 70 | 730 | 802 | 1.760 | 337 | 178 | 1.510 | 215 | 301 | 676 |