

**ELECTRONIC PROGRAMMER**

M programmer: push buttons to control temperature and time.

**OUTSTANDING FEATURES**

Reversing drum action as standard.  
Stainless steel drum as standard.  
Frequency inverter as standard.

**VERSATILITY**

Make to order - customisation.  
OPL > Self-service - Standard OPL model easily trasformable to coin laundry uses.

**ERGONOMICS**

Drawer as fluff filter, stainless steel mesh.  
Biggest door diameters.

**MAINTENANCE**

Hinged control panel: easy and ergonomic access.  
Technical menu: statistics for technicians and maintenance with external console (with console option).

**OTHERS**

White panels.  
COOL DOWN - anti-wrinkle at the end of the cycle.  
Heating options: electric or gas, except DLM2-22 only gas.  
CE approved



**OPTIONS**

- Natural gas heated tumble dryer
- Screen in M programmer (2 units)
- Fluff filter with grid 0,3 mm (standard in STACK is 0,6 mm)
- Maritime wooden packing DLM2-22
- 400V III 60Hz 11/14/18/22kg
- 440V/480V III 60Hz 11/14/18/22kg (maritime)
- Several payment systems for self-service

CAPACITY & DRUM		UNIT.	DLM2-22	
Capacity 1/18		Kg	24,3 x2	
		lb	53,6 x2	
Capacity 1/20		Kg	21,9 x2	
		lb	48,3 x2	
Ø Drum		mm	835	
		inch	32,87	
Drum length		mm	800	
		inch	31,50	
Drum volume		l	440	
		cu ft	15,54	
Ø Door hole		mm	575	
		inch	22,64	
Door center height		mm	547 / 1.618	
		inch	22,60 / 63,70	
Height from floor to bottom of door		mm	286 / 1.330	
		inch	11,26 / 52,36	
ELECTRIC HEATING				
Evaporation capacity		L/h	-	
		US gallon/h	-	
Hourly output		Kg/h	-	
		lb/h	-	
Installed heating power		kW	-	
Installed electrical power		kW	-	
Drum motor power		kW	0,37 x2	
GAS HEATING				
Evaporation capacity (gas model)		L/h	44 x2	
		US gallon/h	11,624 x2	
Hourly output (gas model)		Kg/h	88 x2	
		lb/h	194 x2	
Installed gas heating power		kcal/h	26139 x2	
		Btu/h	103658,5 x2	
Installed gas heating power		kW	30,4 x2	
Installed electrical power		kW	1,94	
Instant propane gas consumption (G31)		Kg/h	2,61 x2	
		lb/h	5,75 x2	
Instant natural gas consumption (G20)		m <sup>3</sup> /h	3,22 x2	
		cfm	1,89 x2	
Ø Gas inlet		BSPP ISO 228-1	3/4"	
VENTILATION				
Fan motor power		kW	0,55 x2	
Nominal air flow rate		m <sup>3</sup> /h	900 x2	
		cfm	529,72 x2	
Ø Fume exhaust		mm	250 x2	
		inch	9,84 x2	
HEAT EMISSION				
Maximum total heat emission		kW	2,6	
		Btu/h	8876,8	
Max. front heat emission		kW	1,9	
		Btu/h	6486,9	
CONNECTIONS			E	G / S
Tension 230V - I + N + T		Nº x mm <sup>2</sup> / A	-	3 x 2,5 / 20A
Tension 230V - III + T		Nº x mm <sup>2</sup> / A	-	3 x 2,5 / 20A (1*)
Tension 400V - III + N + T		Nº x mm <sup>2</sup> / A	-	3 x 2,5 / 20A (2*)
NET DIMENSIONS / D. WITH PACKING				
Net / gross width		mm	870 / 950	
		inch	34,25 / 37,40	

Net / gross depth	mm	1.312 / 1.395
	inch	51,65 / 54,92
Net / gross height	mm	2.118 / 2.250
	inch	83,39 / 88,58
Net / gross weight	Kg	373,5 / 388,5
	lb	823,43 / 856,50
<b>OTHERS</b>		
Sound level	dB	69

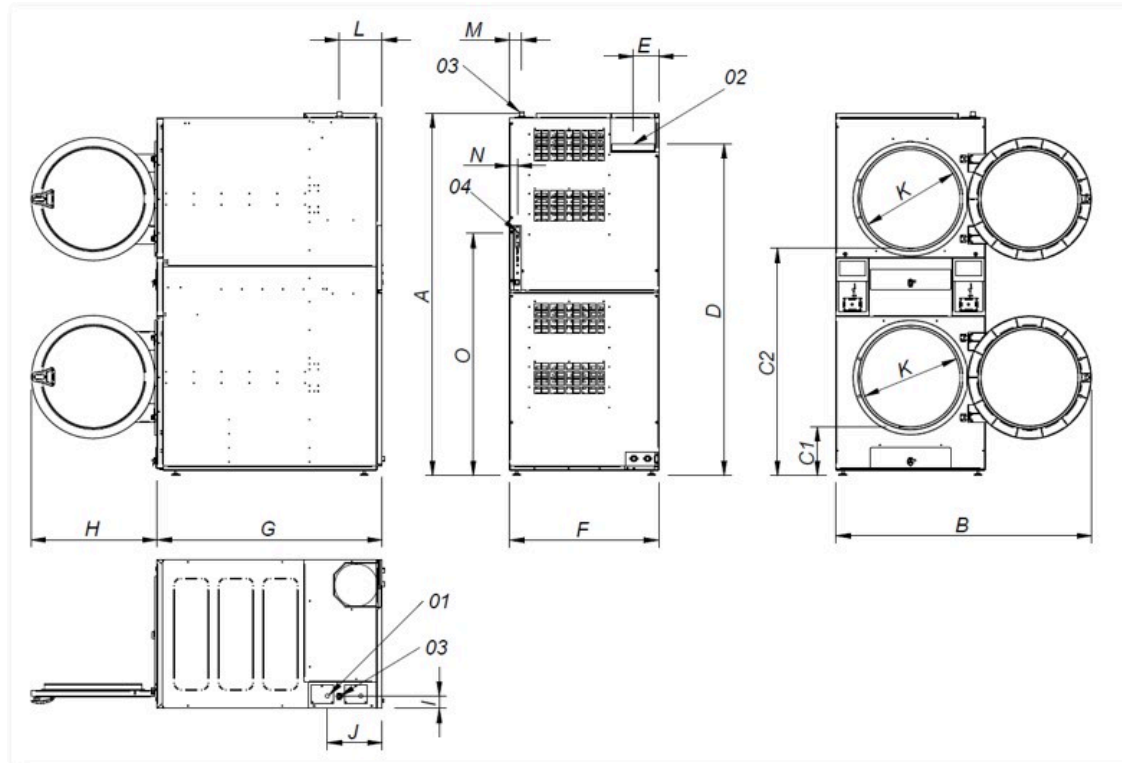

- 01 Power supply
- 02 Fumes output Ø 250
- 03 Gas inlet 3/4"
- 04 Ethernet connection (only TOUCH control)

	A	B	C1	C2	D	E	F	G	H	I	J	K	L	M	N	O
DLM2-22	2.118	1.490	286	1.330	1.940	149	870	1.312	735	73	320	575	250	70	45	1.416