



ELECTRONIC CONTROL

M programmer: push buttons to control temperature and time.



OUTSTANDING FEATURES

Reversing drum action as standard.
Galvanised steel drum.
Frequency inverter as standard.



EFFICIENCY

Big fluff filter.



VERSATILITY

Make to order - customisation.
OPL > Coin laundry - Standard OPL model easily trasformable to coin laundry.



ERGONOMICS

Biggest door diameters.
Opening sense of door adjustable on site.



MAINTENANCE

Hinged control panel: easy and ergonomic access.
Technical menu: statistics for technicians and maintenance with external console (with console option).
Easy to access to components.



OTHERS

White painted panels.
COOL DOWN - anti-wrinkle at the end of the cycle.
Heating options: electric or gas.
CE approved



OPTIONS

- Natural gas heated tumble dryer
- Opposite door opening
- Back panel with air filter
- M programmer display
- Maritime wooden packing DLM-35
- 400V 3N 60 Hz DLM-11-35
- 230V 3~ 50 Hz DLM-22/28/35 E
- 230V 3~ 60 Hz DLM-22/28/35 E
- 230V 3~ 60 Hz DLM-35 G/S
- 440/480V 3~ 60 Hz DLM-22/28/35
- Several payment systems for self-service

CAPACITY & DRUM		UNIT.	DLM-35	
Capacity 1/18		Kg	36,7	
		lb	80,8	
Capacity 1/20		Kg	33	
		lb	72,8	
Ø Drum		mm	947	
		inch	37,28	
Drum length		mm	936	
		inch	36,85	
Drum volume		l	660	
		cu ft	23,30	
Ø Door hole		mm	802	
		inch	31,57	
Door center height		mm	1.040	
		inch	40,94	
Height from floor to bottom of door		mm	578	
		inch	22,74	
ELECTRIC HEATING				
Evaporation capacity		L/h	31,1	
		US gallon/h	8,22	
Hourly output		Kg/h	60	
		lb/h	132,3	
Installed heating power		kW	36	
Installed electrical power		kW	37,15	
GAS HEATING				
Evaporation capacity (gas model)		L/h	32,1	
		US gallon/h	8,480	
Hourly output (gas model)		Kg/h	63,9	
		lb/h	140,9	
Installed gas heating power		kcal/h	35254	
		Btu/h	139899	
Installed gas heating power		kW	41	
Installed electrical power		kW	1,15	
Instant propane gas consumption (G31)		Kg/h	3,51	
		lb/h	7,74	
Instant natural gas consumption (G20)		m³/h	4,34	
		cfm	2,55	
Ø Gas inlet		BSPP ISO 228-1	1/2"	
POWER AND VENTILATION				
Drum motor power		kW	0,55	
Fan motor power		kW	0,55	
Nominal air flow rate		m³/h	1.200	
		cfm	706	
Ø Fume exhaust		mm	200	
		inch	7,87	
HEAT EMISSION				
Maximum total heat emission		kW	3,6	
		Btu/h	12291	
Max. front heat emission		kW	2,5	
		Btu/h	8604	
CONNECTIONS			E	G / S
Tension 230V - I + N + T		Nº x mm² / A	-	3 x 1,5 / 16A
Tension 230V - III + T		Nº x mm² / A	4 x 50 / 125A	3 x 1,5 / 16A
Tension 400V - III + N + T		Nº x mm² / A	5 x 16 / 63A	3 x 1,5 / 16A
NET DIMENSIONS / D. WITH PACKING				
Net / gross width		mm	985 / 1.065	
		inch	38,8 / 41,9	

Net / gross depth	mm	1.210 / 1.310
	inch	47,6 / 51,6
Net / gross height	mm	1.975 / 2.080
	inch	77,8 / 81,9
Net / gross weight	Kg	260 / 285
	lb	573 / 628
OTHERS		
Sound level	dB	65

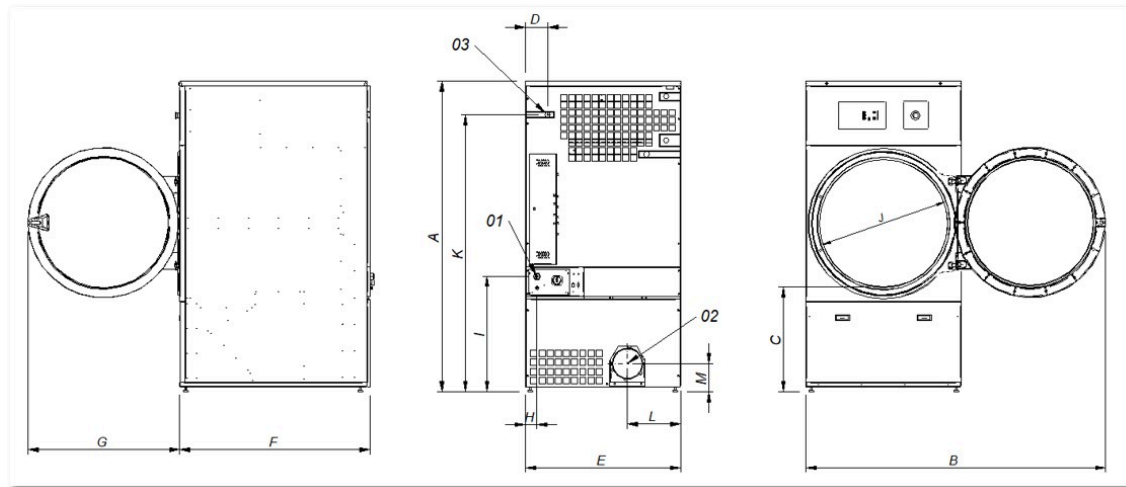

01 Power supply
02 Fumes output Ø 200
03 Gas inlet 1/2"

	A	B	C	D	E	F	G	H	I	J	K	L	M
DLM-28	1.975	1.910	660	141	985	1.054	970	70	730	802	1.768	337	178
DLM-35	1.975	1.910	660	141	985	1.210	970	70	730	802	1.768	337	178