



## ELECTRONIC PROGRAMMER

### PR-1025, PR-1225, PR-1425, PR-2025

Digital screen: precise control of temperature.  
Preset ironing speeds, not adjustable.

### PR-1425, PR-2025 ECO-ENERGY

Simple and user friendly with an **automatic mode**: automatic management of ironing speed according to the selected temperature.  
Digital speed and temperature display.



## EFFICIENCY

Acoustic comfort: 65 dB max.  
Minimum space requirement: space saving, suitable for small spaces.  
Ideal for processing small quantity of flat linen in facilities like restaurants, guest rooms, hostels.



## ROBUSTNESS

Nomex quality coating: resistant to high temperatures (option, standard on ECO-ENERGY).  
Panels in grey Skinplate and stainless steel.  
Wooden feeding board.  
Industrial components, more durable.



## OUTSTANDING FEATURES

Large roll contact area with the linen.  
Roll lifting control by pedal or automatic roll lifting control by foot cell detection.  
Two available models:
 

- **Standard**: roll with cotton polyester coating.
- **Nomex**: roll with Nomex coating.

### ECO-ENERGY Models:

Large roll contact area with the linen.  
Mode of operation identical to a flatwork ironer: no roll lifting, more ergonomic.  
Models equipped with Nomex belts, suction and variable speed inverter, more productivity.  
Adjustable speed and temperature.



## MAINTENANCE

Easy installation: requires only an electrical connection.  
Easy access on both sides for maintenance.  
Quick and easy dismantling of bearings.



## OTHERS

Front feeding and return.  
Roll Ø 250 mm.  
Working widths: 1.000, 1.200, 1.400 and 2.000 mm.  
Electric heating.  
CE certification.

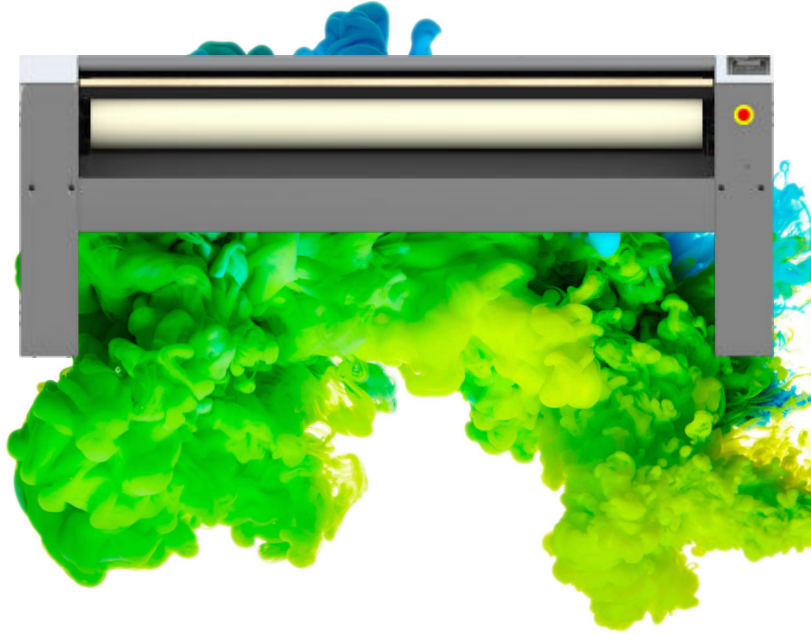

## OPTIONS

- Pedal control instead of photocell (no need in ECO-ENERGY)
- 230V I + N 50Hz (except PR-2025 ECO-ENERGY)
- 400V +N+T 60Hz
- 440V III No N 60Hz (maritime)

GENERAL DETAILS		UNIT.	PR-2025
Theoretical production: 20-25 humidity		Kg/h	35
		Lb/h	77,16
Roll Ø		mm	250
		inch	9,84
Working width		mm	2.000
		inch	78,74
Working speed		m/min	4.2
		ft/mn	13,77
Electronic control		-	YES
Chest motion		-	Automático
POWER			
Heating power		Kw	12
Roll motor power		Kw	0,18
Total electric power		Kw	12,18
CONNEXIONS			
Tension 230 V I + N + T		nº x mm²/A	-
		nº x AWG/A	-
Tension 230 V III + T		nº x mm²/A	4 x 6 / 32A
		nº x AWG/A	4 x 9 / 32A
Tension 400 V III + N + T		nº x mm²/A	5 x 4 / 20A
		nº x AWG/A	5 x 11 / 20A
DIMENSIONS			
Net / gross width		mm	2.462 / 2.490
		inch	96,93 / 98,03
Net / gross depth		mm	484 / 540
		inch	19,06 / 21,26
Net / gross height		mm	985 / 1.130
		inch	38,78 / 44,49
Net / gross weight		Kg	164 / 184
		Lb	361,56 / 405,65
Net / gross volume		m³	1,17 / 1,51
		ft³	41,32 / 53,33
OTHERS			
No. Fume outlet		Nº	-
Ø Fume outlet		mm	-
		inch	-
Air flow		m³/h	-
		cfm	-
Noise Level		dB	55

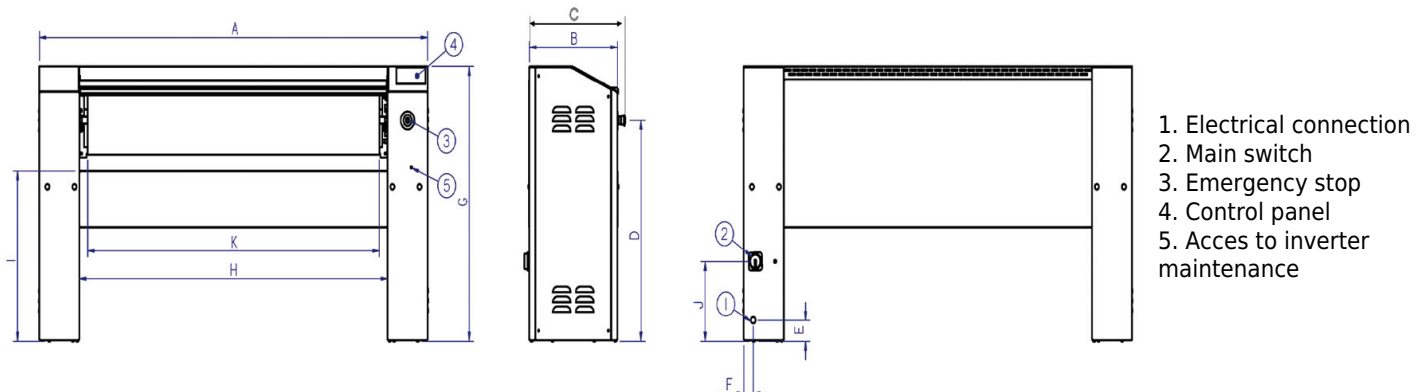

	A	B	C	D	E	F	G	H	I	J	K
PR-1025	1.462	423	484	791	75	45	985	1.079	610	287	988
PR-1225	1.662	423	484	791	75	45	985	1.279	610	287	1.198
PR-1425	1.862	423	484	791	75	45	985	1.479	610	287	1.398
PR-2025	2.462	423	484	791	75	45	985	2.079	610	287	1.998