

 **ELECTRONIC PROGRAMMER**

M programmer: push buttons to control temperature and time.

 **OUTSTANDING FEATURES**

Reversing drum action as standard.
Galvanised steel drum.
Frequency inverter as standard.

 **EFFICIENCY**

Big fluff filter.

 **VERSATILITY**

Make to order - customisation.
OPL > Coin laundry - Standard OPL model easily trasformable to coin laundry.

 **ERGONOMICS**

Biggest door diameters.
Opening sense of door adjustable on site.

 **MAINTENANCE**

Hinged control panel: easy and ergonomic access.
Technical menu: statistics for technicians and maintenance with external console (with console option).
Easy to access to components.

 **OTHERS**

White painted panels.
COOL DOWN - anti-wrinkle at the end of the cycle.
Heating options: electric or gas.
CE approved



OPTIONS

- Opposite door opening
- Back panel with air filter
- M programmer display
- Maritime wooden packing DLM-28
- 400V III 60Hz DLM-11/14/18/22/28/35
- 230V III 50Hz DLM-22/28/35
- 230V III 60Hz DLM-22/28/35 E
- 230V III 60Hz DLM-11 to DLM-35 G/S
- 440/480V III 60Hz DLM-22/28/35
- Several payment systems for self-service

CAPACITY & DRUM		UNIT.	DLM-28	
Capacity 1/18		Kg	30,6	
		lb	67,3	
Capacity 1/20		Kg	27,5	
		lb	60,6	
Ø Drum		mm	947	
		inch	37,28	
Drum length		mm	780	
		inch	30,71	
Drum volume		l	550	
		cu ft	19,42	
Ø Door hole		mm	802	
		inch	31,57	
Door center height		mm	1.040	
		inch	40,94	
Height from floor to bottom of door		mm	578	
		inch	22,74	
ELECTRIC HEATING				
Evaporation capacity		L/h	26,1	
		US gallon/h	6,9	
Hourly output		Kg/h	48,4	
		lb/h	106,7	
Installed heating power		kW	30	
Installed electrical power		kW	31,15	
Drum motor power		kW	0,55	
GAS HEATING				
Evaporation capacity (gas model)		L/h	30,9	
		US gallon/h	8,163	
Hourly output (gas model)		Kg/h	59,3	
		lb/h	130,7	
Installed gas heating power		kcal/h	35276	
		Btu/h	139986,5	
Installed gas heating power		kW	41	
Installed electrical power		kW	1,15	
Instant propane gas consumption (G31)		Kg/h	3,51	
		lb/h	7,74	
Instant natural gas consumption (G20)		m ³ /h	4,34	
		cfm	2,55	
Ø Gas inlet		BSPP ISO 228-1	1/2"	
VENTILATION				
Fan motor power		kW	0,55	
Nominal air flow rate		m ³ /h	1.200	
		cfm	706,29	
Ø Fume exhaust		mm	200	
		inch	7,87	
HEAT EMISSION				
Maximum total heat emission		kW	3	
		Btu/h	10242,4	
Max. front heat emission		kW	2,1	
		Btu/h	7169,7	
CONNECTIONS			E	G / S
Tension 230V - I + N + T		Nº x mm ² / A	-	3 x 1,5 / 16A
Tension 230V - III + T		Nº x mm ² / A	4 x 35 / 100A	3 x 1,5 / 16A
Tension 400V - III + N + T		Nº x mm ² / A	5 x 16 / 63A	3 x 1,5 / 16A
NET DIMENSIONS / D. WITH PACKING				
Net / gross width		mm	985 / 1.065	
		inch	38,78 / 41,93	

Net / gross depth	mm	1.054 / 1.154
	inch	41,50 / 45,43
Net / gross height	mm	1.975 / 2.080
	inch	77,76 / 81,89
Net / gross weight	Kg	230 / 260
	lb	507,06 / 573,20
OTHERS		
Sound level	dB	65

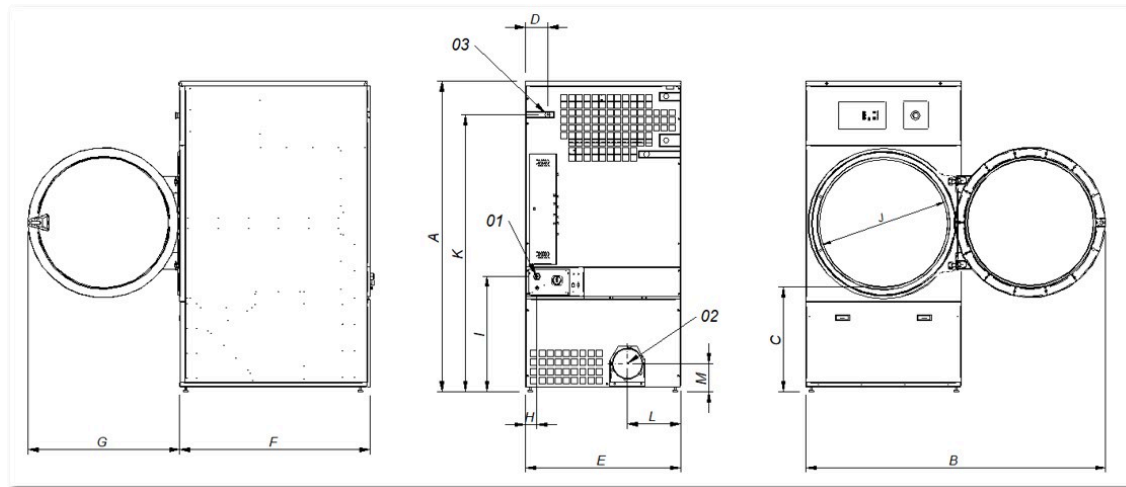

01 Power supply
02 Fumes output Ø 200
03 Gas inlet 1/2"

	A	B	C	D	E	F	G	H	I	J	K	L	M
DLM-28	1.975	1.910	660	141	985	1.054	970	70	730	802	1.768	337	178
DLM-35	1.975	1.910	660	141	985	1.210	970	70	730	802	1.768	337	178