

TOUCH II

- **TOUCH II:** easy-to-use microprocessor, fully programmable with 7" touchscreen.
- Multilingual interface.
- Unlimited programmes: in addition to presets, create as many as your business needs.
- USB port: configure, update, and analyse machines without an internet connection.

EFFICIENCY

- **EFFICIENT IRON:** automatically adjusts ironing speed based on residual moisture, saving energy.
- **OPTIMAL FEEDING:** automatic speed adjustment - slower for feeding, faster for higher output, up to 15 m/min (standard).
- Excellent heat transfer thanks to the roller's material and thickness.
- Auto stop at 80 °C: extends lifespan of ironing belts.
- Gas circuit at the bottom, reducing energy consumption.
- Accurate temperature control via microprocessor: low energy use.
- Models with radiant gas burner: up to 25% more output - saving time and energy.

ROBUSTNESS

- Roller with inverter.
- Panels in skinplate.
- Ironing belts in Nomex: resistant to high temperatures.
- Nickel-plated cylinder - corrosion-resistant and longer lasting (optional).

ERGONOMICS

- Acoustic comfort: max 65 dB.
- Easy to clean, more hygienic.
- Optimal feeding height: 1,120 mm.
- LED indicator 3 ironing zones for easier operation (optional).

MAINTENANCE

- Easy access to all components on both sides of the machine.
- Connections: electrical and flue gas.
- Comprehensive technical menu: statistics, self-test, data retrieval for technicians and maintenance.
- Remote communication: rapid intervention.

VERSATILITY

- Radiant gas model: flexibility for higher output and better adaptation to high-ceiling spaces.
- Key options:
 - **SRE:** Standard rear outlet without folder (new).
 - **LF:** Front outlet with integrated folder.
 - **LFRE:** Front and rear outlet with integrated folder.
 - **CPL-CROSS:** External transverse folder.

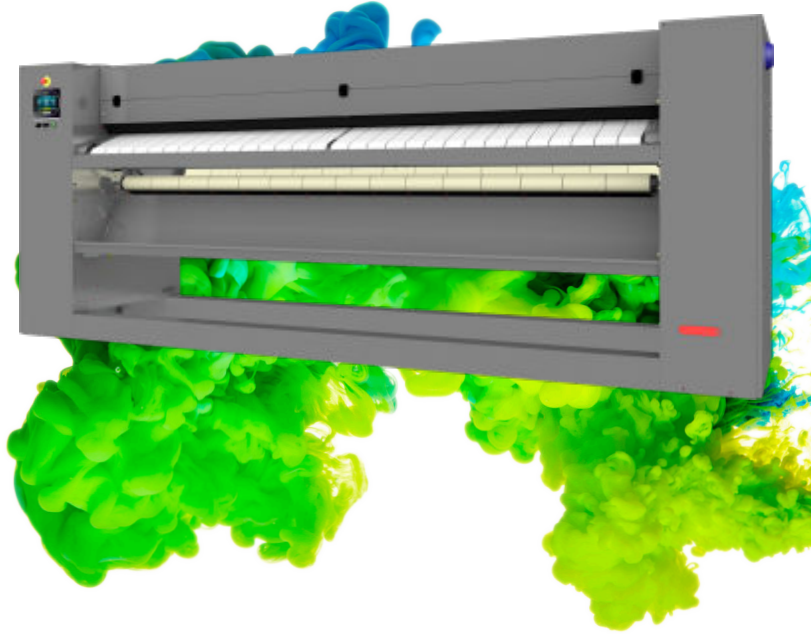

OPTIONS

- Feeding tray CF-3365
- Leveling feet kit
- 3-zone LED ironing indicator
- Nickel plated roll CF-3365 (except steam model)
- Gas LPG option (Propan)
- Gas NG option (Natural Gas)
- Built-in lengthfolder CF-3365 (front exit)
- Built-in lengthfolder + rear and front exit CF-3365
- Cross folder CPL-CROSS CF-3365
- Rear exit without folder CF-3365
- No drop tray (laundry recovery) CF-3365
- Antistatic belts for CF-3365 ironers without folder
- Antistatic ironing belts + bar CF-3365 for folder
- Maritime wooden packing for CF-3365
- 230V 3~ 50/60Hz CF-3365 E
- 230V 3~ 60Hz CF-3365 G
- 440V 3~ 50/60Hz CF-3365 E (marine)
- 120V 1~ + N 60Hz CF-3365 G (Gas US)

GENERAL DETAILS	UNIT.	CF-3365 TOUCH II	
Theoretical output Electric heating* standard mod. front or rear exit	Kg/h	160	
	lb/h	353	
Theoretical output Electric heating* mod. Folder front exit	Kg/h	112	
	lb/h	247	
Theoretical output Electric heating* mod. Folder front and rear exit	Kg/h	104	
	lb/h	229	
Theoretical production Gas atmo heating*	Kg/h	N/A	
	lb/h	N/A	
Theoretical production Radiant gas heating* mod standard front or rear exit	Kg/h	184	
	lb/l	406	
Theoretical production Radiant gas heating* mod folder front exit	Kg/h	129	
	lb/l	264	
Theoretical production Radiant gas heating* mod folder front and rear exit	Kg/h	120	
	lb/l	264	
Roll Ø	mm	650	
	inch	25,59	
Working width	mm	3.300	
	inch	129,92	
Height floor-feeding belts	mm	1.170	
	inch	46,06	
Working speed standard mod.	m/min	0,5 - 15	
	ft/min	1,6 - 49	
Working speed mod. with folder	m/min	2 - 10	
	ft/min	6,5 - 32	
Electronic control	-	TOUCH II	
No. Programs	-	5	
Lenght folder	-	OPT.	
Rear exit	-	OPT.	
Large surface contact with linen	-	305°	
POWER			
Roll motor power	Kw	0,61	
Fan motor power	Kw	0,5	
Electric mod.: heating power	Kw	72	
Electric mod: Total electric power	Kw	73,11	
Gas mod.: heating power	Kw	78	
Gas mod.: total electric power	Kw	1,11	
Steam mod.: heating power	Kw	97	
Steam mod.: total electric power	Kw	1,11	
Steam consumption	Kg/h	102	
Additional electric power mod. SRE (Rear exit, without folder)	Kw	0,28	
Additional electric power mod. LF (with folder, front exit)	Kw	0,66	
Additional electric power mod. LFRE (with folder, front and rear exit)	Kw	0,76	
CONNECTIONS		E	G/S
Tension 230V - I + N + T	Nº x mm² / A	N/A	3 x 2,5 / 10A
	nº x AWG/A	N/A	3 x 13 / 10A
Tension 230V - III + T	Nº x mm² / A	N/A	4 x 2,5 / 10A
	nº x AWG/A	N/A	4 x 13 / 10A
Tension 400V - III + N + T	Nº x mm² / A	5 x 25 / 125A	5 x 2,5 / 10A
	nº x AWG/A	5 x 3 / 125A	5 x 13 / 10A
Ø Gas inlet	BSP	1/2"	
Ø Steam inlet	BSP	3/4"	
Ø Condensed (Steam models)	BSP	1/2"	
OVERALL DIMENSIONS / PACKING DIMENSIONS			
Net width / Gross width	mm	4410 / 4590	
	inch	173,6 / 180,7	
Net depth (with rear exit open) / gross depth	mm	1175 (1480) / 1360	
	inch	46,3 (58,2) / 53,5	

Net height / gross height	mm	1780 / 1940
	inch	70,1 / 76,4
Net weight / gross weight standard mod.	kg	1965 / 2065
	lbs	4332 / 4553
Net weight / gross weight standard mod. with rear exit	kg	2015 / 2115
	lbs	4442 / 4663
Net weight / gross weight mod. Folder front exit	kg	2095 / 2195
	lbs	4619 / 4839
Net weight / gross weight mod. Folder front and rear exit	kg	2175 / 2275
	lbs	4795 / 5016
Net volume (with rear exit) / Gross volume	m ³	9,22 (11,32) / 12,11
	f ³	326 (399,9) 428

OTHERS

No. Fume outlet	Nº	2
Ø Fume outlet	mm	153
	inch	6,0
Air Flow	m ³ /h	1.200
	cfm	706
Sound level	dB	65
	l/h	83
Evaporation power standard mod.	USgallon/h	21,9
	l/h	58
Evaporation power mod. Folder front exit	USgallon/h	15,3
	l/h	54
Evaporation power mod. Folder front and rear exit	USgallon/h	14,2

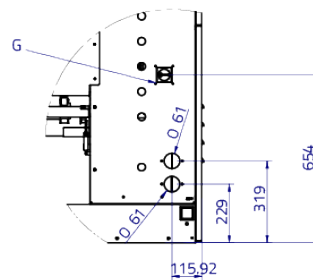
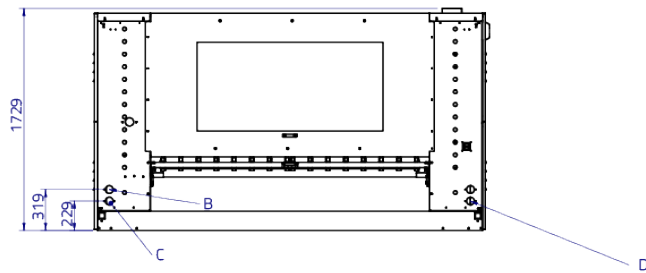
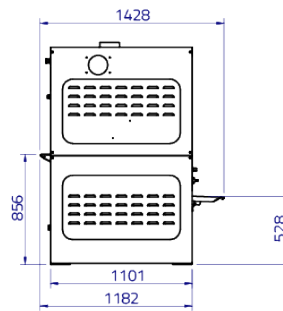
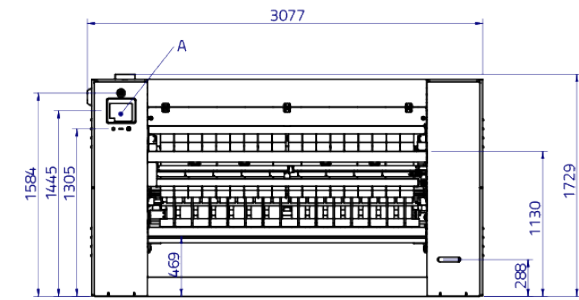

- A. Touch-screen control tablet
- B. Steam outlet ø1/2" male
- C. Gas inlet ø22 or steam ø3/4" male
- D. Electrical inlet
- E. NO EXHAUST
- F. (Exhaust) ø152 external
- G. Isolator

