



## ELECTRONIC CONTROL

### NPR-1025, NPR-1225, NPR-1425, NPR-2025

- Digital screen: precise control of temperature.
- Preset ironing speeds, not adjustable.

### NPR-1425, NPR-2025 ECO-ENERGY

- Simple and user friendly with an **automatic mode**: automatic management of ironing speed according to the selected temperature.
- Digital speed and temperature display.



## EFFICIENCY

- Acoustic comfort: 65 dB max.
- Minimum space requirement: space saving, suitable for small spaces.
- Ideal for processing small quantity of flat linen in facilities like restaurants, guest rooms, hostels.
- Speed control via potentiometer as an option.
- Heating plate with improved adaptation to different fabric thicknesses.



## ROBUSTNESS

- Nomex quality coating: resistant to high temperatures (option, standard on ECO-ENERGY).
- Panels in grey Skinplate and stainless steel.
- Wooden feeding board.
- Industrial components, more durable.
- Gas spring located under the tray: less exposed to heat, no risk of leaks.
- Temperature probe screwed to the plate with thermal paste: no risk of damage.
- Klixon thermostat for greater safety and reliability.



## OUTSTANDING FEATURES

- Large roll contact area with the linen.
- Roll lifting control by pedal or automatic roll lifting control by foot cell detection.
- Two available models:
  - **Standard**: roll with cotton polyester coating.
  - **Nomex**: roll with Nomex coating.
- **NPR ECO-ENERGY Models**:
  - Large roll contact area with the linen.
  - Mode of operation identical to a flatwork ironer: no roll lifting, more ergonomic.
  - Models equipped with Nomex belts, suction and variable speed inverter, more productivity.
  - Adjustable speed and temperature.



## MAINTENANCE

- Easy installation: requires only an electrical connection.
- Easy access on both sides for maintenance.
- Quick and easy dismantling of bearings.
- Thermostat and probe accessible from the rear without removing the heating plate.



## OTHERS

- Front feeding and return.
- Roll Ø 250 mm. Working widths: 1.000, 1.200, 1.400, 2.000mm.
- Electric heating.
- CE certification.

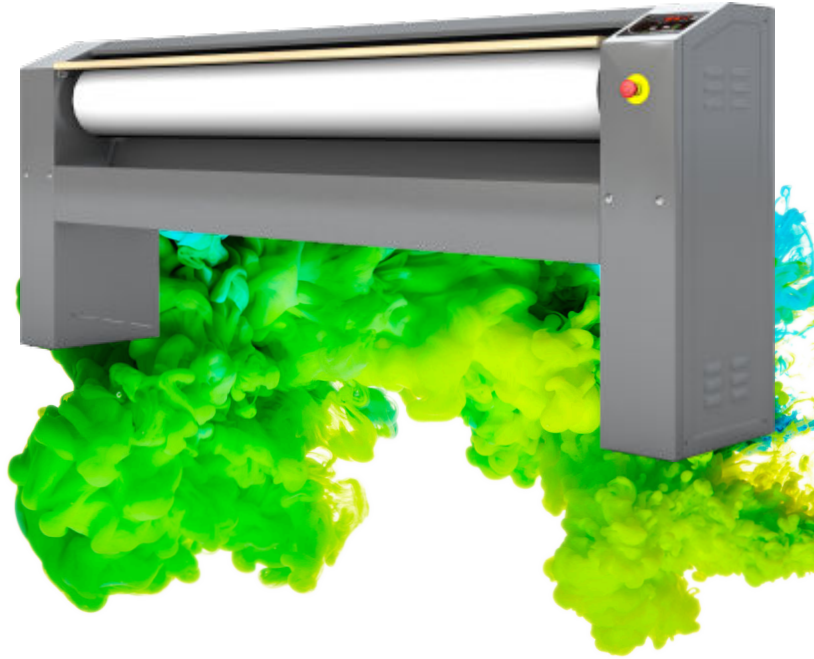

## OPTIONS

- Pedal control instead of photocell
- 230V 1~ + N 50Hz(except mod. 200 ECO-ENERGY)
- 400V 3~ + N + T 60Hz
- 440V 3~ (No N) 60Hz (marine)

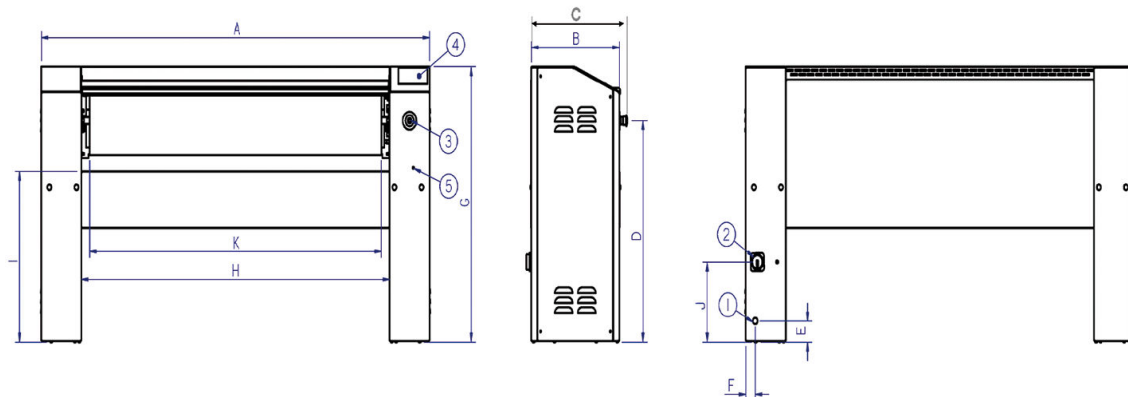

1. Electrical connection
2. Main switch
3. Emergency stop
4. Control panel
5. Acces to inverter maintenance

	A	B	C	D	E	F	G	H	I	J	K
PR-1025	1.462	423	484	791	75	45	985	1.079	610	287	988
PR-1225	1.662	423	484	791	75	45	985	1.279	610	287	1.198
PR-1425	1.862	423	484	791	75	45	985	1.479	610	287	1.398
PR-2025	2.462	423	484	791	75	45	985	2.079	610	287	1.998