

TOUCH II

User friendly and totally programmable microprocessor with 7" touch screen.
USB Connection. Online platform free of charge for programming, telemetry, data analysis...thanks to the IoT.
Videos show on display: ads, instructions, (useful for coin laundry).
37 languages.

OUTSTANDING FEATURES

Reversing drum action as standard.
Stainless steel drum as standard.
Frequency inverter as standard.

EFFICIENCY

DOUBLE FLOW - mixed axial-radial airflow.
Big fluff filter.

VERSATILITY

Make to order - customisation.
Wet Cleaning.
OPL > Self-service - Standard OPL model easily trasformable to coin laundry uses.

CONNECTIVITY

IoT- **DOMUSCONNECT** standard.
Management of laundries: OPL and COIN.
Remote payment (coin-laundry).

ERGONOMICS

Drawer as fluff filter, stainless steel mesh.
Biggest door diameters.

MAINTENANCE

Hinged control panel: easy and ergonomic access.
Technical menu: statistics for technicians.

OTHERS

Grey skinplate outer casing, stainless steel look.
SOFT DRY - new drum with stamped holes.
COOL DOWN - anti-wrinkle at the end of the cycle.
Heating options: electric or gas, except DTT2-22 only gas.
CE approved



OPTIONS

- License IoT - DOMUSCONNECT
- Natural gas heated tumble dryer
- EFFICIENT DRY for STACK (order 1 unit per column)
- Double doorglass (order 1 unit per column)
- Fire extinguisher SFEX STACK (order 1 unit per column)
- Tropicalized model (order 1 unit per column)
- Opposite door opening (order 1 unit per column)
- Dosing-spraying of perfume (1 unit x column)
- Fluff filter with grid 0,3 mm (standard in STACK is 0,6 mm)
- Back panel with air filter (STACK)
- Stainless steel front and side panels DTT2-18
- Front panel in stainless steel DTT2-11/14/18
- Maritime wooden packing DTT2-18
- 400V III 50Hz 11/14/18kg
- 400V III 60Hz 11/14/18/22kg
- 230V III 60Hz 11/14/18kg G
- 230V III 60Hz 11/14/18kg E
- 440V/480V III 60Hz 11/14/18/22kg (maritime)
- Several payment systems for self-service

CAPACITY & DRUM	UNIT.	DTT2-18 TURBO	
Capacity 1/18	Kg	18,3 x2	
	lb	40,4 x2	
Capacity 1/20	Kg	16,5 x2	
	lb	36,3 x2	
Ø Drum	mm	750	
	inch	29,53	
Drum length	mm	746	
	inch	29,37	
Drum volume	l	330	
	cu ft	11,64	
Ø Door hole	mm	574	
	inch	22,60	
Door center height	mm	547 / 1522	
	inch	21,54 / 59,92	
Height from floor to bottom of door	mm	260 / 1235	
	inch	10,24 / 48,62	
ELECTRIC HEATING			
Evaporation capacity	L/h	-	
	US gallon/h	-	
Hourly output	Kg/h	-	
	lb/h	-	
Installed heating power	kW	-	
Installed electrical power	kW	-	
Drum motor power	kW	0,37 x2	
GAS HEATING			
Evaporation capacity (gas model)	L/h	35,3 x2	
	US gallon/h	9,325 x2	
Hourly output (gas model)	Kg/h	70,7 x2	
	lb/h	155,9 x2	
Installed gas heating power	kcal/h	20650 x2	
	Btu/h	81891,4 x2	
Installed gas heating power	kW	24 x2	
Installed electrical power	kW	1,94	
Instant propane gas consumption (G31)	Kg/h	2,06 x2	
	lb/h	4,54 x2	
Instant natural gas consumption (G20)	m ³ /h	2,54 x2	
	cfm	1,49 x2	
Ø Gas inlet	BSPP ISO 228-1	1/2"	
VENTILATION			
Fan motor power	kW	0,55 x2	
Nominal air flow rate	m ³ /h	750 x2	
	cfm	441,43 x2	
Ø Fume exhaust	mm	200 x2	
	inch	7,78 x2	
HEAT EMISSION			
Maximum total heat emission	kW	2,5	
	Btu/h	8353,4	
Max. front heat emission	kW	1,8	
	Btu/h	6145,5	
CONNECTIONS			
Tension 230V - I + N + T	Nº x mm ² / A	E	G / S
Tension 230V - III + T	Nº x mm ² / A	-	3 x 2,5 / 20A
Tension 400V - III + N + T	Nº x mm ² / A	-	3 x 2,5 / 20A (1*)
		-	3 x 2,5 / 20A (2*)
NET DIMENSIONS / D. WITH PACKING			
Net / gross width	mm	785 / 865	
	inch	30,91 / 34,06	

Net / gross depth	mm	1.443 / 1.457
	inch	53,81 / 57,36
Net / gross height	mm	1.980 / 2.126
	inch	77,95 / 83,70
Net / gross weight	Kg	320 / 349
	lb	705,48 / 769,41
OTHERS		
Sound level	dB	64

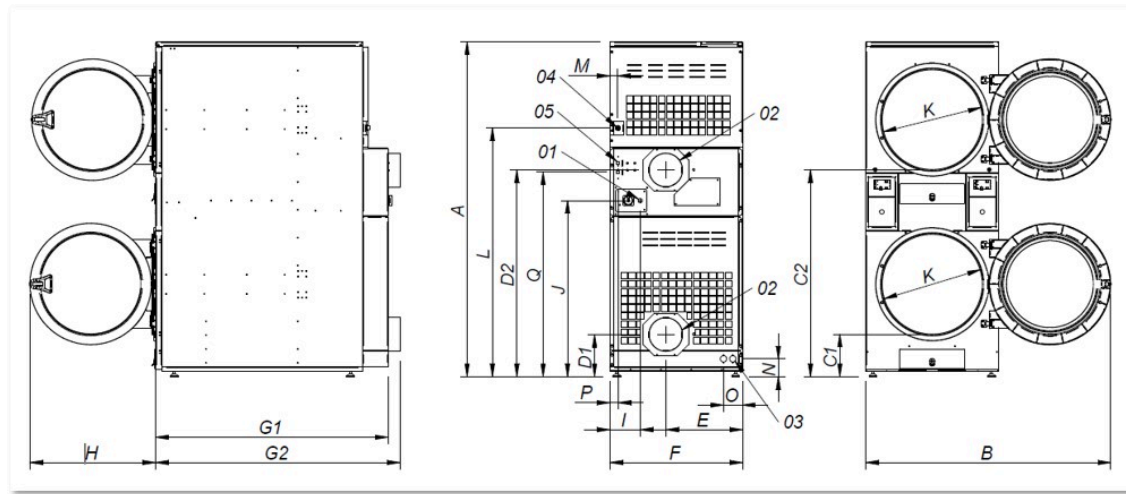

- 01 Power supply
- 02 Fumes output Ø 200
- 03 2 sprinkler valves 3/4"
- 04 Gas inlet 1/2"
- 05 Ethernet connection (only TOUCH control)

	A	B	C1	C2	D1	D2	E	F	G1	G2	H	I	J	K	L	M	N	O	P	Q
DTT2-18 TURBO	1.980	1.447	259	1.234	250	1.223	454	785	1.374	1.443	735	180	1.040	575	1.472	45	103	100	49	1.210