



## ELECTRONIC PROGRAMMER

M programmer: push buttons to control temperature and time.



## OUTSTANDING FEATURES

Reversing drum action as standard.  
Stainless steel drum as standard.  
Frequency inverter as standard.



## EFFICIENCY

DOUBLE FLOW - mixed axial-radial airflow.  
Big fluff filter.



## VERSATILITY

Make to order - customisation.  
OPL > Coin laundry- Standard OPL model easily trasformable to coin laundry uses.



## ERGONOMICS

Drawer as fluff filter, stainless steel mesh.  
Biggest door diameters.  
Opening sense of door adjustable on site.



## MAINTENANCE

Hinged control panel: easy and ergonomic access.  
Technical menu: statistics for technicians and maintenance with external console (with console option).  
Easy to access to components.



## OTHERS

Grey skinplate outer casing, stainless steel look.  
**NEW:** Geared motor drive on models DTT-45 to DTT-80  
SOFT DRY - new drum with stamped holes.  
COOL DOWN - anti-wrinkle at the end of the cycle.  
Heating options: electric, gas or steam.  
CE approved



## OPTIONS

- Natural gas heated tumble dryer
- Reinforced drum for heavy-duty use 28-35kg
- Double doorglass DTM-35/45/60/80
- Opposite door opening DTM-11-35
- M programmer display for DTM-11-35
- Back panel with air filter
- Rear panel with external air intake and filter DTM-11-35
- Fluff filter with grid 0,6 mm (standard is 0,3 mm)
- Fluff filter with grid 1,2 mm (standard is 0,3 mm)
- Stainless steel front and side panels DTM-35
- Front panel in stainless steel DTM-28/35
- Steam battery in stainless steel DTM-28/35
- Low pressure steam battery DTM-28/35
- Maritime wooden packing DTM-35
- 400V 3N 60 Hz DTM-11-35
- 230V 3~ 50 Hz DTM-22/28/35 E
- 230V 3~ 60 Hz DTM-22/28/35 E
- 230V 3~ 60 Hz DTM-11-35 G/S
- 440/480V 3~ 60 Hz DTM-22/28/35 (marine)
- Several payment systems for self-service

CAPACITY & DRUM	UNIT.	DTM-35
Capacity 1/18	Kg	36,7
	lb	80,8
Capacity 1/20	Kg	33
	lb	72,8
Ø Drum	mm	947
	inch	37,28
Drum length	mm	936
	inch	36,85
Drum volume	l	660
	cu ft	23,30
Ø Door hole	mm	802
	inch	31,57
Door center height	mm	1.040
	inch	40,94
Height from floor to bottom of door	mm	578
	inch	22,74
ELECTRIC HEATING		
Evaporation capacity	L/h	31,1
	US gallon/h	8,22
Hourly output	Kg/h	60
	lb/h	132,3
Installed heating power	kW	36
Installed electrical power	kW	37,15
GAS HEATING		
Evaporation capacity (gas model)	L/h	32,1
	US gallon/h	8,480
Hourly output (gas model)	Kg/h	63,9
	lb/h	140,87
Installed gas heating power	kcal/h	35254
	Btu/h	139899
Installed gas heating power	kW	41
Installed electrical power	kW	1,15
Instant propane gas consumption (G31)	Kg/h	3,51
	lb/h	7,74
Instant natural gas consumption (G20)	m³/h	4,34
	cfm	2,55
Ø Gas inlet	BSPP ISO 228-1	1/2"
STEAM HEATING		
Installed steam heating power	kW	50,10
	Btu/h	170948
Installed electrical power	kW	1,15
Steam consumption (8 barG) - Standard	kg/h	89
Steam consumption (116 psiG)	lb/h	107,2
Steam pressure	barG	6 - 9
	psiG	87 - 130,5
Standard steam inlet - outlet	BSPT- ISO7.1	1"
Standard steam inlet - outlet	NPT ANSI B1.20.1 Tapered	1"
Steam consumption (5 barG) - Low Pressure	kg/h	93
Steam consumption (72,5 psiG) - Low Pressure	lb/h	112
Steam pressure (low pressure)	barG	3 - 6
	psiG	43,5 - 97
Low pressure steam inlet - outlet	BSPT- ISO7.1	1" 1/2
THERMAL OIL HEATING		
Installed heating power	kW	-
Installed electrical power	kW	-
Fluid consumption (T max 175°C)	m³/h	-
Thermal oil connection	BSP	-

POWER AND VENTILATION			
Drum motor power	kW	0,55	
Fan motor power	kW	0,55	
Nominal air flow rate	m³/h	1.200	
	cfm	706	
Ø Fume exhaust	mm	200	
	inch	7,87	
HEAT EMISSION			
Maximum total heat emission	kW	3,6	
	Btu/h	12291	
Max. front heat emission	kW	2,5	
	Btu/h	8604	
CONNECTIONS		E	G / S
Tension 230V - I + N + T	Nº x mm² / A	-	3 x 1,5 / 16A
Tension 230V - III + T	Nº x mm² / A	4 x 50 / 125A	3 x 1,5 / 16A
Tension 400V - III + N + T	Nº x mm² / A	5 x 16 / 63A	3 x 1,5 / 16A
NET DIMENSIONS / D. WITH PACKING			
Net / gross width	mm	985 / 1.065	
	inch	38,8 / 41,9	
Net / gross depth	mm	1.210 / 1.310	
	inch	47,6 / 51,6	
Net height / gross height without heating	mm	1.975 / 2.080	
	inch	77,8 / 81,9	
Net / gross weight	Kg	260 / 285	
	lb	573 / 628	
OTHERS			
Sound level	dB	65	

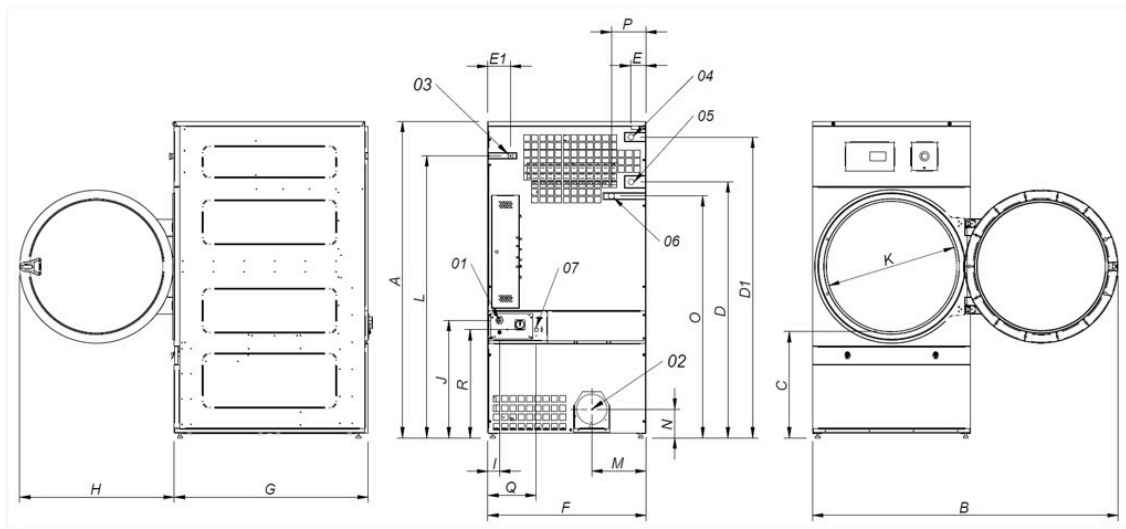

- 01 Power supply
- 02 Fumes output Ø 200
- 03 Gas inlet 1/2"
- 04 Steam inlet 1"
- 05 Condensate 1"
- 06 Sprinkler valve 3/4"
- 07 Ethernet connection (only TOUCH Control)

	A	B	C	D	D1	E	E1	F	G	H	I	J	K	L	M	N	O	P	Q	R
DTM-28	1.975	1.910	660	1.590	1.875	102	130	985	1.054	970	70	730	802	1.760	337	178	1.510	215	301	676
DTM-35	1.975	1.910	660	1.590	1.875	102	130	985	1.210	970	70	730	802	1.760	337	178	1.510	215	301	676