

ELECTRONIC PROGRAMMER

PR-1025, PR-1225, PR-1425, PR-2025

Digital screen: precise control of temperature.
Preset ironing speeds, not adjustable.

PR-1425, PR-2025 ECO-ENERGY

Simple and user friendly with an **automatic mode**: automatic management of ironing speed according to the selected temperature.
Digital speed and temperature display.

EFFICIENCY

Acoustic comfort: 65 dB max.
Minimum space requirement: space saving, suitable for small spaces.
Ideal for processing small quantity of flat linen in facilities like restaurants, guest rooms, hostels.

ROBUSTNESS

Nomex quality coating: resistant to high temperatures (option, standard on ECO-ENERGY).
Panels in grey Skinplate and stainless steel.
Wooden feeding board.
Industrial components, more durable.

OUTSTANDING FEATURES

Large roll contact area with the linen.
Roll lifting control by pedal or automatic roll lifting control by foot cell detection.
Two available models:

- **Standard**: roll with cotton polyester coating.
- **Nomex**: roll with Nomex coating.

ECO-ENERGY Models:

Large roll contact area with the linen.
Mode of operation identical to a flatwork ironer: no roll lifting, more ergonomic.
Models equipped with Nomex belts, suction and variable speed inverter, more productivity.
Adjustable speed and temperature.

MAINTENANCE

Easy installation: requires only an electrical connection.
Easy access on both sides for maintenance.
Quick and easy dismantling of bearings.

OTHERS

Front feeding and return.
Roll Ø 250 mm.
Working widths: 1.000, 1.200, 1.400 and 2.000 mm.
Electric heating.
CE certification.

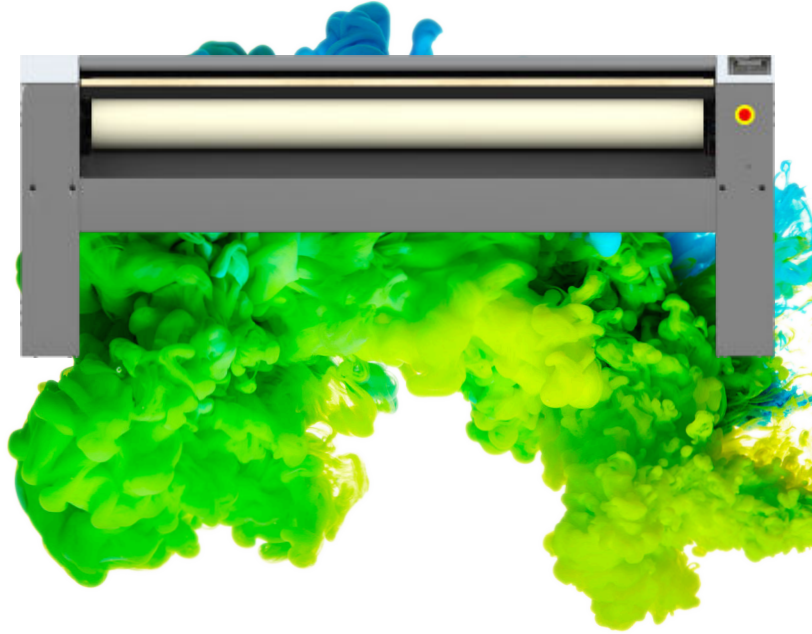

OPTIONS

- Pedal control instead of photocell (no need in ECO-ENERGY)
- 230V I + N 50Hz (except PR-2025 ECO-ENERGY)
- 400V +N+T 60Hz
- 440V III No N 60Hz (maritime)

| GENERAL DETAILS | UNIT. | PR-1225 NOMEX |
|--|------------|-----------------|
| Theoretical production: 20-25 humidity | Kg/h | 27,50 |
| | Lb/h | 60,63 |
| Roll Ø | mm | 250 |
| | inch | 9,84 |
| Working width | mm | 1.200 |
| | inch | 47,24 |
| Working speed | m/min | 4.2 |
| | ft/mn | 13,77 |
| Electronic control | - | YES |
| Chest motion | - | Automático |
| POWER | | |
| Heating power | Kw | 6 |
| Roll motor power | Kw | 0,18 |
| Total electric power | Kw | 6,18 |
| CONNEXIONS | | |
| Tension 230 V I + N + T | nº x mm²/A | 3 x 6 / 32A |
| | nº x AWG/A | 3 x 9 / 32A |
| Tension 230 V III + T | nº x mm²/A | 4 x 4 / 20A |
| | nº x AWG/A | 4 x 11 / 20A |
| Tension 400 V III + N + T | nº x mm²/A | 5 x 2,5 / 10A |
| | nº x AWG/A | 5 x 13 / 10A |
| DIMENSIONS | | |
| Net / gross width | mm | 1.662 / 1.690 |
| | inch | 65,43 / 65,43 |
| Net / gross depth | mm | 484 / 540 |
| | inch | 19,06 / 21,26 |
| Net / gross height | mm | 985 / 1.130 |
| | inch | 38,78 / 44,49 |
| Net / gross weight | Kg | 124 / 134 |
| | Lb | 273,37 / 295,42 |
| Net / gross volume | m³ | 0,79 / 1,03 |
| | ft³ | 27,90 / 36,37 |
| OTHERS | | |
| No. Fume outlet | Nº | - |
| Ø Fume outlet | mm | - |
| | inch | - |
| Air flow | m³/h | - |
| | cfm | - |
| Noise Level | dB | 55 |

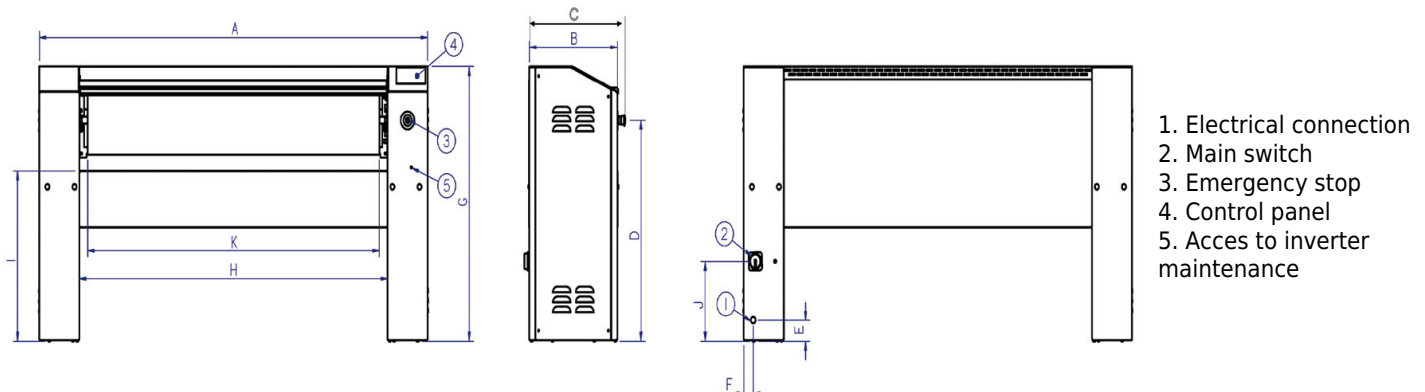

| | A | B | C | D | E | F | G | H | I | J | K |
|---------------|-------|-----|-----|-----|----|----|-----|-------|-----|-----|-------|
| PR-1025 NOMEX | 1.462 | 423 | 484 | 791 | 75 | 45 | 985 | 1.079 | 610 | 287 | 988 |
| PR-1225 NOMEX | 1.662 | 423 | 484 | 791 | 75 | 45 | 985 | 1.279 | 610 | 287 | 1.198 |
| PR-1425 NOMEX | 1.862 | 423 | 484 | 791 | 75 | 45 | 985 | 1.479 | 610 | 287 | 1.398 |
| PR-2025 NOMEX | 2.462 | 423 | 484 | 791 | 75 | 45 | 985 | 2.079 | 610 | 287 | 1.998 |